

# Prefabricated Modular Data Center Solution

Scalability | Flexibility | Efficiency

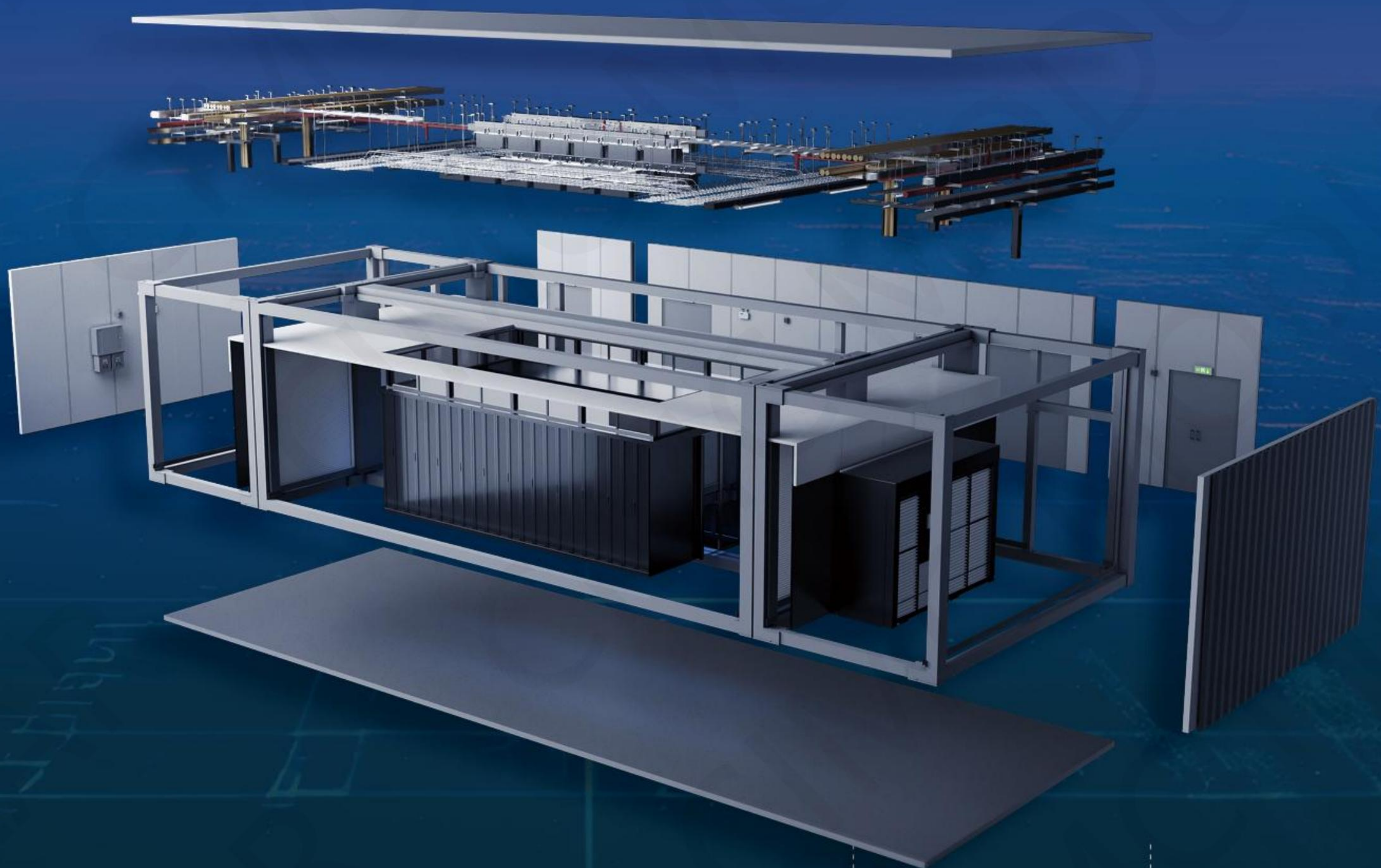

# China International Marine Containers(Group) Ltd.(CIMC)

Diversified multinational industrial group and world leading supplier of logistics and energy equipment.



## CIMC Modular Since 2004

Integrating advanced equipment manufacturing with high-quality green building practices, CIMC has introduced an innovative construction model, named CIMC Modular, which uses a steel structure including various elements like enclosure, MEP works, decoration, and more. About 90% of the building processes can be shifted into a controlled factory setting, which provides superior-quality products for the industry.

As a division of the CIMC Group, CIMC Modular has been leading the way in the industry for 20 years and expanding EPC (Engineering, Procurement, and Construction) sector within the domestic market, operating under Shenzhen CIMC Construction.

## CIMC Modular Building Malaysia



As the Southeast Asian market continues to evolve, CIMC Modular is strategically expanding its presence in the region. In November 2023, CIMC Modular Building Malaysia Sdn Bhd was established, marking a significant milestone in the company's regional growth strategy. This subsidiary is dedicated to offering localized services to clients within the Malaysian market, ensuring proximity and tailored solutions to meet their specific needs. It is also certified by CIDB, which underscores its commitment to quality and standards.

### R&D Capacity

100+ Engineers  
Team Fully BIM Design



### EPC Project Management

GC License in China  
Experienced MP Team, Sub-cons



**CIMC**

### Production Capacity

Multiple Production bases  
Productivity: 5000+ units/year



### Global Delivery

Private Cargo Terminal  
20+ Years Global Delivery Experience



# Why Choose Us

## 9 Application Areas

School



Apartment



Office Building



Camp



Data Center



Transitional and Affordable Housing Projects



Hospitality and Cultural Tourism Industry



Anti-epidemic Emergency



Medical Industry



It is prefabricated in the factory with a completion rate of

**90%**

It can reduce the total construction period by

**50%**

It can reduce the construction waste by

**90%**



- Global independent intellectual property rights
- Global recognition of the building quality
- Rapid construction in large batches
- Widely used in the global market
- Global logistics and installation service

With leading technology, high-quality products, and a global business layout, CIMC has provided global users with approximately



**100,000**  
building modules



finished products that cover an area of  
**4,000,000 m<sup>2</sup>**



a cumulative total of **over 200**  
projects

## Global Access

The modular solutions meet permanent construction standards for most countries worldwide. Complies with local building codes in countries as China, the EU, the UK, the Us, Australia, and Singapore, etc.

# Modular DC Solutions

With the rapid development of



Cloud Computing



Big Data



IoT



AI

The demand for the construction of data centers has been increased dramatically. The data center construction industry stands in dire need of a technological revolution.

However

## Traditional Data Center Construction



Long  
Construction  
Cycle



Heavy  
Dependence on  
Local Labor



Uncontrollable  
Quality



On-Site  
Management  
Schedule



Difficulties  
of Delayed  
Construction

To address these industry pains



## Prefabricated Modular Data Center Solution

Construction Cycle shortened by **50%**

Factory completion rate of modules reaches **85%**

Industrialized production with controllable quality

Difficulty of construction management reduced by **60%**

Risk of delivery delay reduced by **50%**

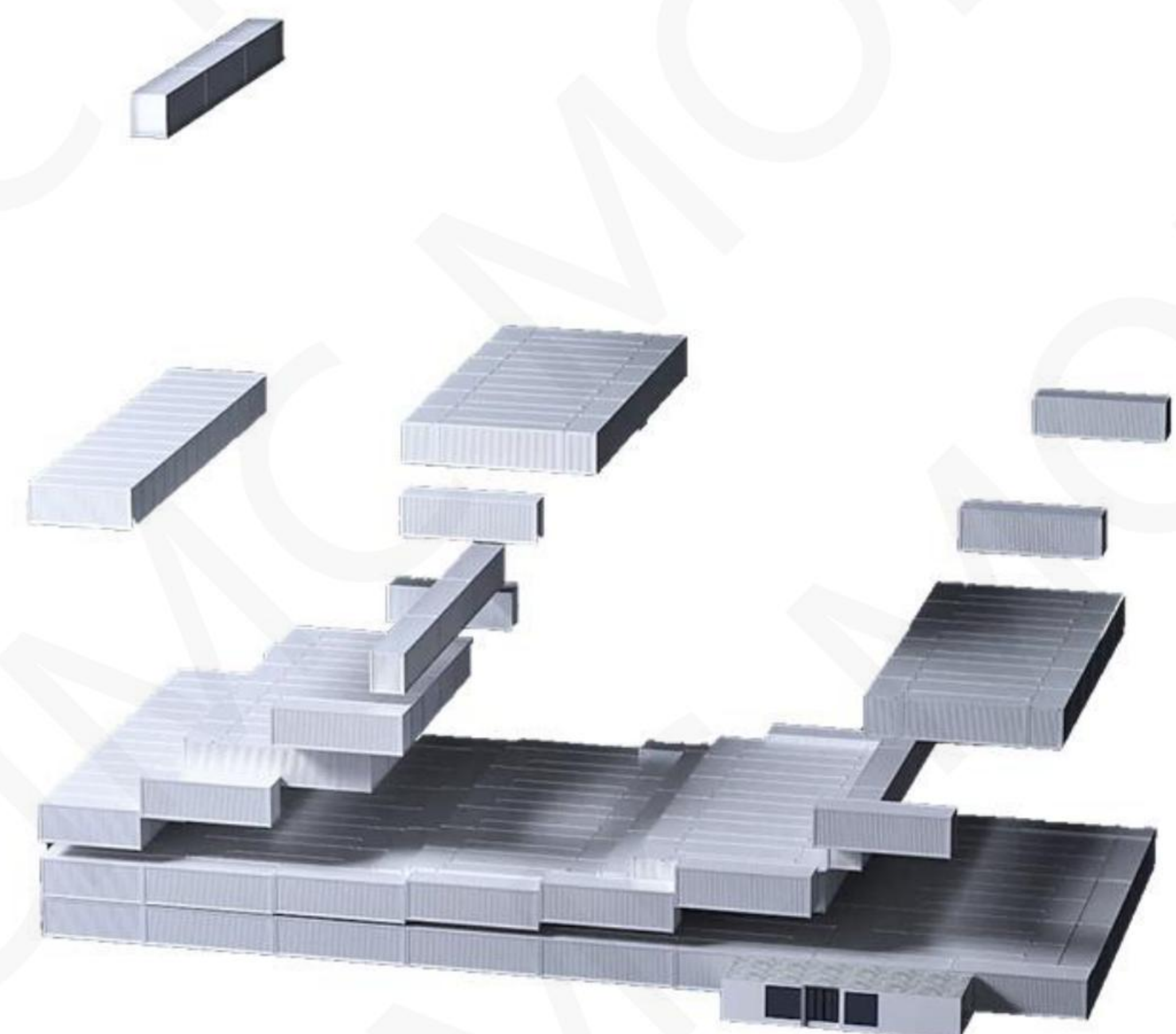

# Modular DC Solutions

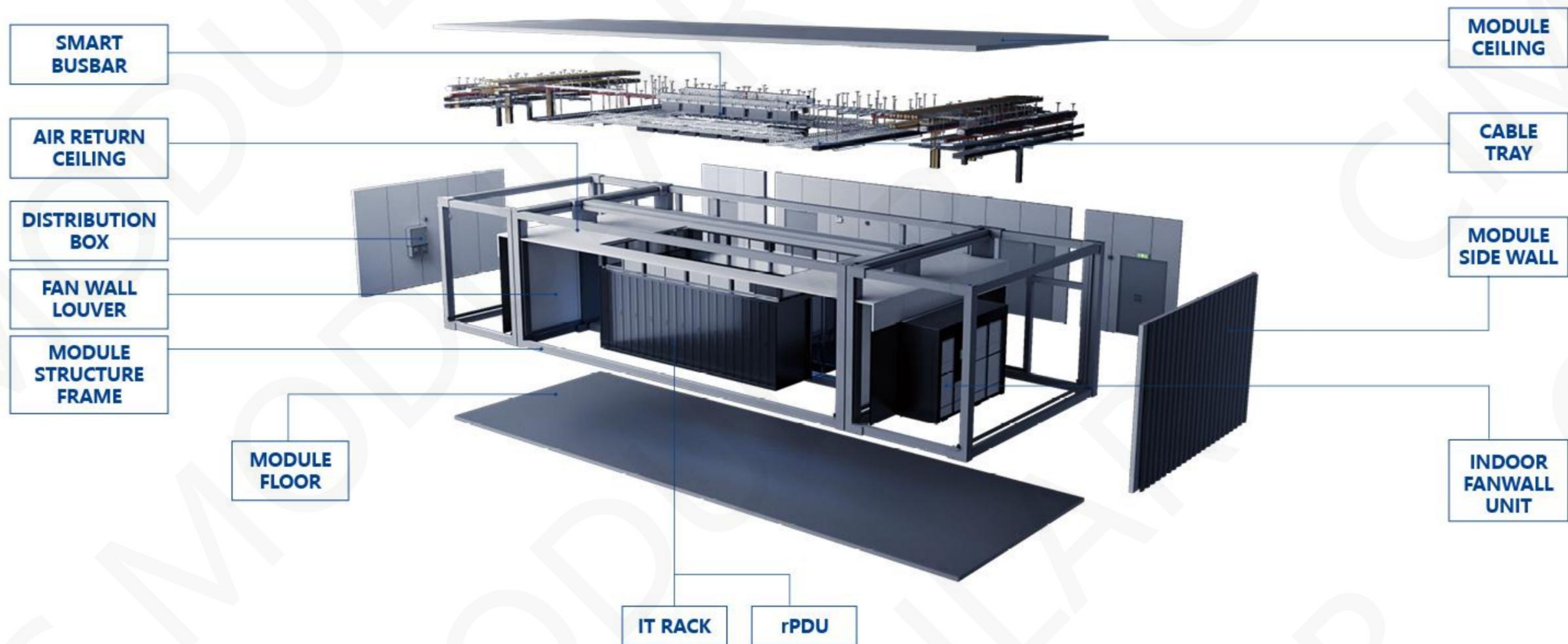

- Fully prefabricated IT equipment module, MEP module (cooling), power module, auxiliary module...
- Pre-integrated and Cx1 FAT completed
- LEGO assembly
- Minimize on-site workload
- Construction cycle 7-9 months
- Supports fast deploy and capacity expansion

## 4.15M Height Solution

- Recommended for mid-low-density data center
- No raised floor, floor-mounted
- Less than 52U/Rack
- DX air cooling, chilled water or liquid cooling



## 7M Height Solution

- Recommended for both mid-low-density and high-density data center
- 300-1200mm raised floor, floor-mounted
- More than 52U/Rack
- DX air cooling, chilled water and liquid cooling



# Modular DC Solutions



## Skid Modules + Traditional Building for Cost-Efficiency Solution



Construction Cycle shortened by **30%**

Factory completion rate of modules reaches **50%**

Difficulty of construction management reduced by **40%**

Risk of delivery delay reduced by **30%**

- Skid Modules as non-structure components
- Pre-integrated and pre-tested
- Drawer-type assembly
- Traditional building constructed concurrently
- Reduce on-site workload
- Construction cycle: 12-15 months
- Supports fast deploy and capacity expansion



- Stackable for unlimited ceiling height
- Flexible module type, quantity, and layout
- More than 42U/Rack
- Liquid-cooling, air-cooling

# Successful Cases of DC

Now, CIMC has completed the construction of approximately 100,000m<sup>2</sup> of data centers for global clients, supplying about 3,000 modules and 10,000 cabinets.

All projects are permanent buildings and comply with local building codes and acceptance specifications.

CIMC is responsible for detailed design, production manufacturing, integrated wiring, integrated equipment installation, transportation, lifting, module joining, commissioning, and other full-process management tasks.

## Ulanqab Cloud DC ▶

Finished in : 2019

Floors : 5

Floor Area : 9223 sqm / block

Scale : 368 modules / block

1072 it racks / block



## ◀ Langfang Cloud DC

Finished in : 2020

Floors : 5

Floor Area : 9460 sqm / block

Scale : 372 modules / block

1072 it racks / block



## Dongguan Tai Ke Yuan DC ▶

Finished in : 2019

Floors : 5

Floor Area : 5928 sqm / block

Scale : 172modules / block

1152 it racks / block



## ◀ Bahrain Cloud DC

The largest modular data center project in the Middle East



# Global Project Experience



GS(2016)1663

## Contact Us

📍 China Office Address: 25F, New Times Plaza, No.1, Taizi Road, Nanshan District, Shenzhen

📞 Tel: +86 755 21614789

📍 Malaysia Office Address: Suite 14-01, Level 14, Menara JLAND, JBCC, Jalan Tun Abdul Razak, 80000 Johor Bahru, Johor

📞 Tel: +60 7 7069901

✉ E-mail: [cimcmodular@cimc.com](mailto:cimcmodular@cimc.com)

🌐 Website: [www.cimc-modular.com](http://www.cimc-modular.com)